

- PROPOSED REVOCATION OF WAITING AND LOADING RESTRICTION.
 - PROPOSED NO PARKING, LOADING OR UNLOADING ON FOOTWAY OR CYCLEWAY RESTRICTION
 - PROPOSED NO WAITING AT ANY TIME RESTRICTION (DOUBLE YELLOW LINES).
 - PROPOSED SHARED FOOTWAY/CYCLEWAY AREA.
- ALL EXISTING WAITING & LOADING RESTRICTION TO REMAIN THE SAME UNLESS AFFECTED BY THE PROPOSALS

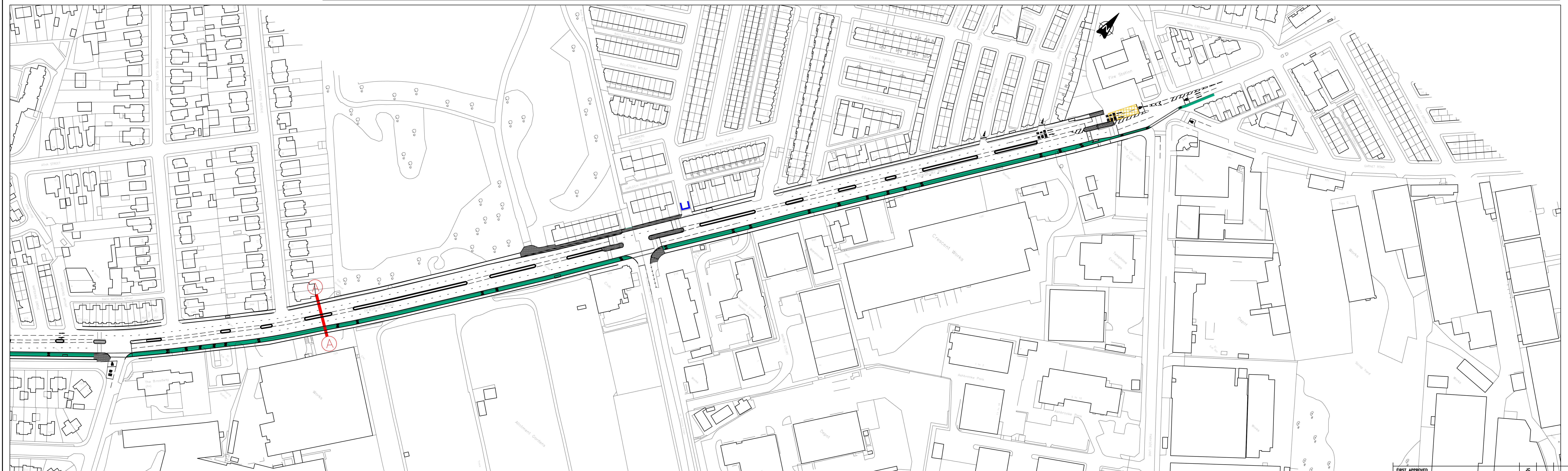
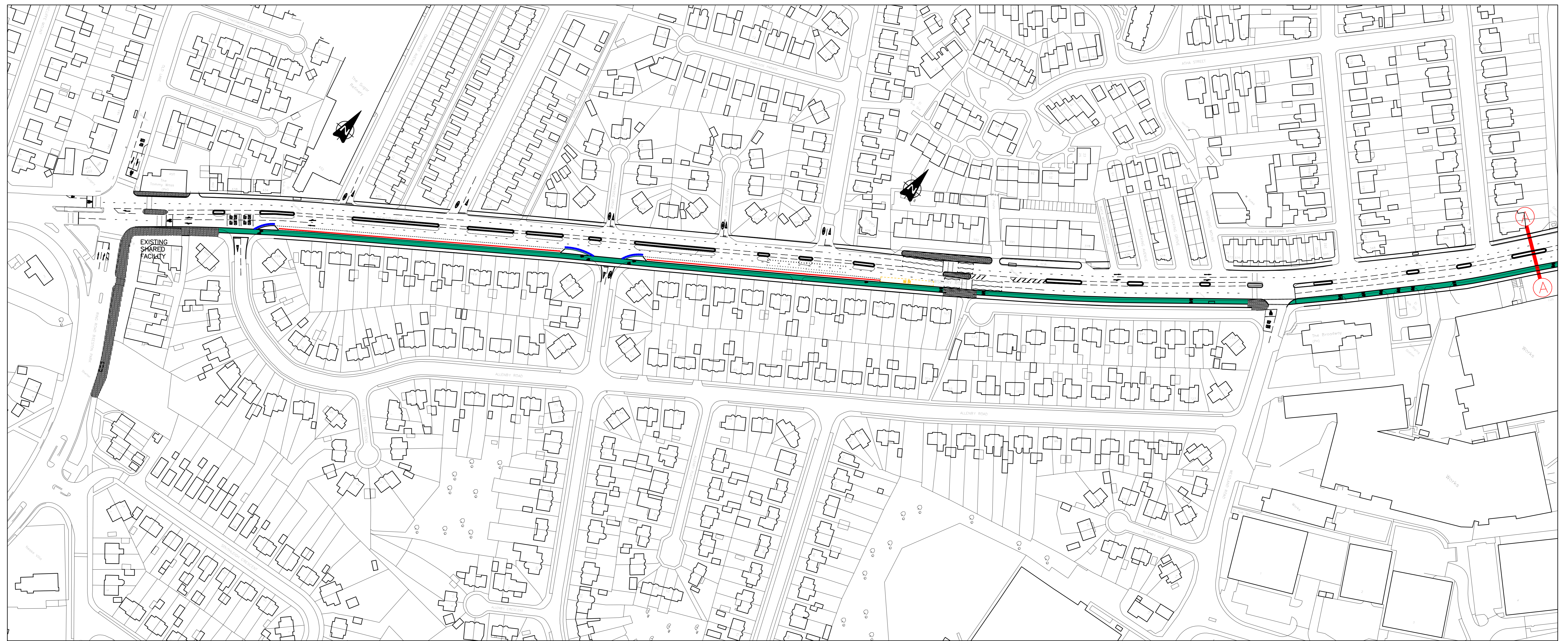

Copyright © 2020 Leeds City Council. All rights reserved.
 This drawing is the property of Leeds City Council. It must only be used for the purpose for which it was originally supplied. It must not be copied, published or transmitted by any means to any third party, without the express permission of the originator. Modification or manipulation of all or part of this drawing is strictly forbidden, unless specifically requested or approved by the originator.

CITY CONNECT – PHASE 3
A653 DEWSBURY ROAD, LEEDS
TRAFFIC REGULATION ORDER

AMENDMENTS	DRAWN	CHECK	DATE	DRAWN BY	SCALE
FIRST APPROVED	JC			JC	1:1000
				AutoCAD BY	
				JC	
				CHECKED BY	
				JC	
				DATE	
				ORIGINAL SHEET SIZE	A0



TM/00/471/01/01	
FOR CONSULTATION ONLY	
STATUS:	DRAFT
DATE:	February 2020
P01.1	SO